

# P

Paulmann

## Safety Instructions



0,1,2,3,4,6,7,9,11,  
15,16,22,23,26,27



Info Hotline

+49 (0) 5041 998 389

Mon. - Fr. 9<sup>h</sup> - 20<sup>h</sup>

Sa. 10<sup>h</sup> - 17<sup>h</sup>



Paulmann Licht GmbH  
32832 Springe / Germany  
[www.paulmann.com](http://www.paulmann.com)

Art.-Nr.:  
461.01

1/2008 1/10

Page 02/02



Safety Instructions  
Nr. 0,1,2



Safety Instructions  
Nr. 0,1,2



Safety Instructions  
Nr. 4

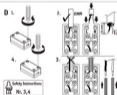

Safety Instructions  
Nr. 3,4

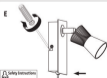

Safety Instructions  
Nr. 4

A, B, C, D, E

