

P

Paulmann

Safety Instructions



11,15,26,27

 Info Hotline 

+49 (0) 5041 998 389

Mon. - Do. 7⁰⁰ - 20⁰⁰

Fr. 7⁰⁰ - 17⁰⁰



Paulmann Licht GmbH
31832 Springe / Germany
www.paulmann.com

Art.-Nr.:

701.16

701.59

(+MA 173)

PBO 12/09

A

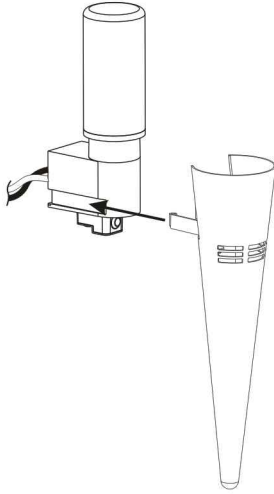

B

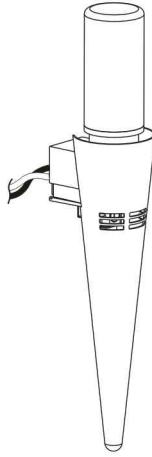

C

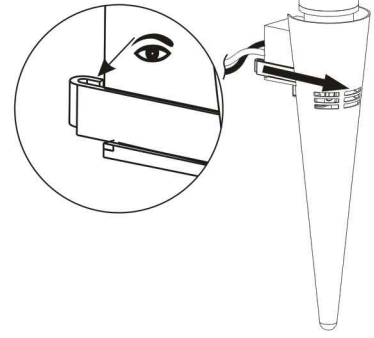

D

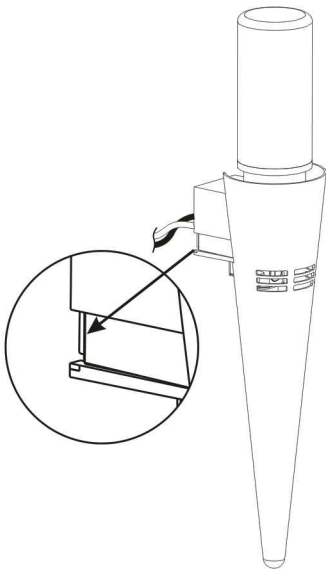

E

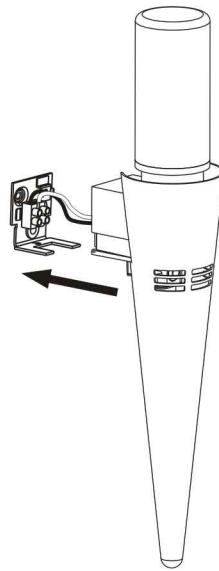

F

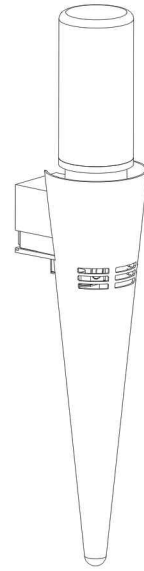

G

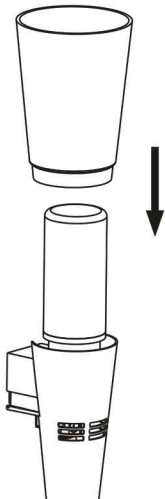

H

