

SAFETY INSTRUCTIONS



### SAFETY INSTRUCTIONS



0, 1, 2, 5a, 5b, 6, 7, 8,  
11, 15, 18, 22



7<sup>00</sup>-20<sup>00</sup>  
Mon. - Fri.

**PAULMANN LICHT GmbH**  
Quezinger Feld 2 • D-31832 Springe  
[www.Paulmann.de](http://www.Paulmann.de)

+49 (0) 5041 998 389

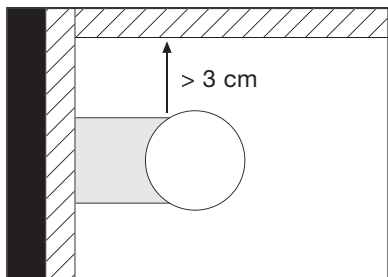
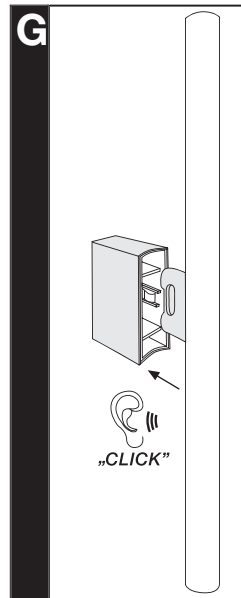
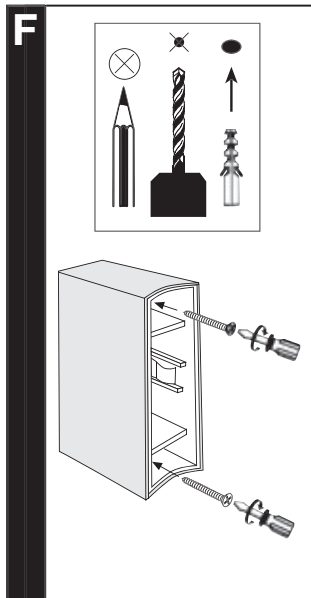
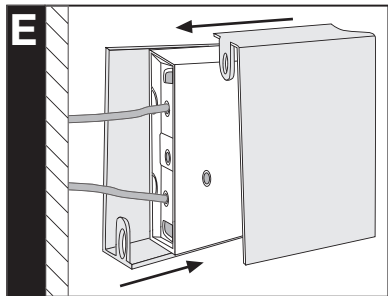
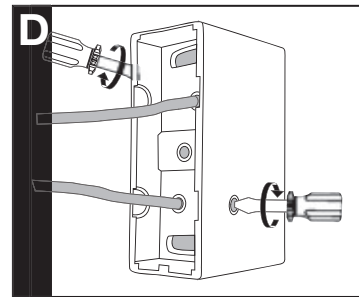
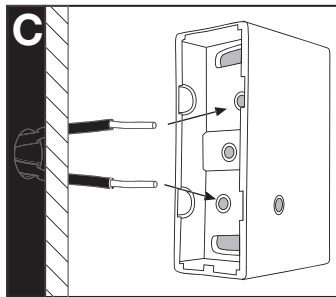
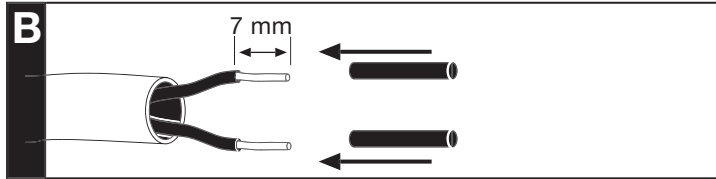
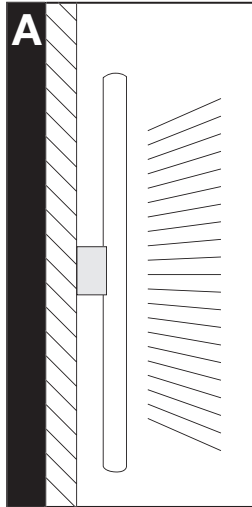

SAFETY INSTRUCTIONS



### SAFETY INSTRUCTIONS



0, 1, 2, 5a, 5b, 6, 7, 8,  
11, 15, 18, 22



7<sup>00</sup>-20<sup>00</sup>  
Mon. - Fri.

**PAULMANN LICHT GmbH**  
Quezinger Feld 2 • D-31832 Springe  
[www.Paulmann.de](http://www.Paulmann.de)

+49 (0) 5041 998 389

