

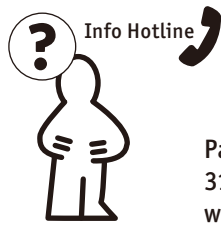

Safety Instructions



0, 1, 2, 3, 4, 6, 7, 8, 9, 10, 11, 15, 18, 22, 25, 26, 27



Info Hotline **+49 (0) 5041 998 389**
Mon. - Do. 7⁰⁰ - 20⁰⁰
Fr. 7⁰⁰ - 17⁰⁰

Paulmann Licht GmbH
31832 Springe / Germany
www.paulmann.com

Art.-Nr.: **602.90**

(+MA 173)

PEA 06/14

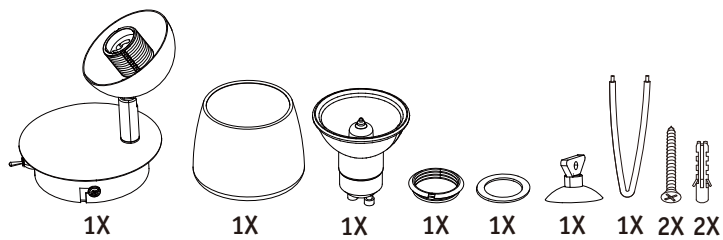

incl.
1x 40W
GZ10



Paulmann
Art.-Nr. 800.44

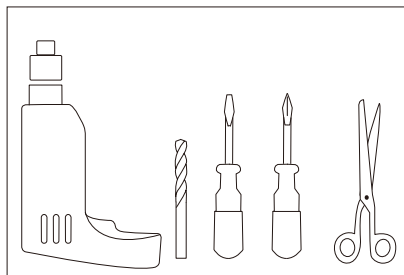

A

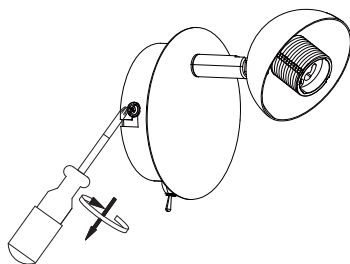

B

Safety Instructions
Nr. 0, 1, 2

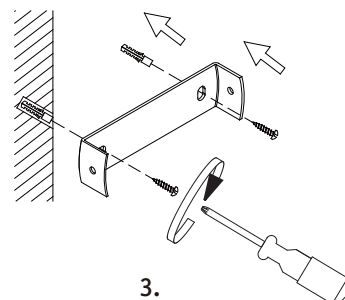
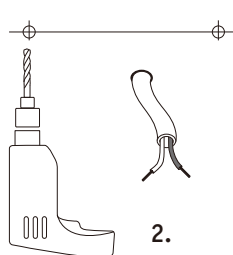
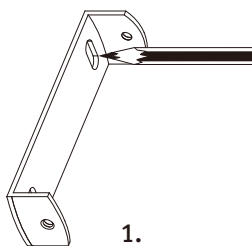

C

Safety Instructions
Nr. 0, 1, 4

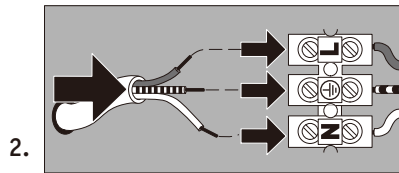
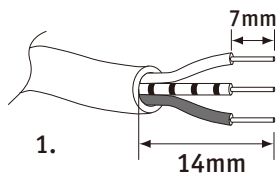

230V

D

Safety Instructions
Nr. 4

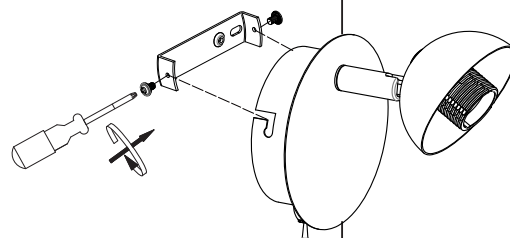

E

Safety Instructions
Nr. 0, 1, 4

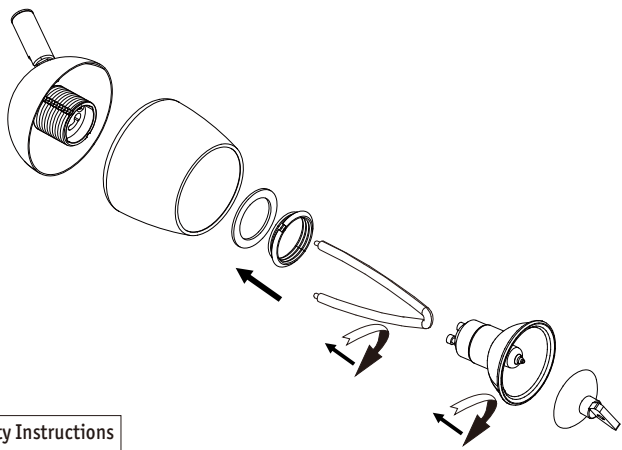

F

Safety Instructions
Nr. 9

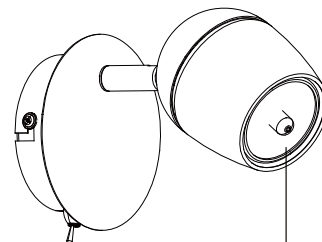

max.
40W

>0.5m =