



# Safety Instructions



0, 1, 6, 8, 11, 12, 15,  
22, 23, 25, 28



Info Hotline **+49 (0) 5041 998 389**

Mon. - Do. 7<sup>00</sup> - 20<sup>00</sup>

Fr. 7<sup>00</sup> - 17<sup>00</sup>

Paulmann Licht GmbH  
31832 Springe / Germany  
www.paulmann.com

Art.-Nr.:  
701.96/97/98 702.05/  
06/07/08/09/10/11/12  
13/14/52/53/54/55/57  
703.09/10/11/12/17/18  
20/21/32/33/36/37/38  
704.07/08/31/36/82/  
83/84/85  
705.02/03/04/05/06/07  
(+MA 173)   
POW 03/14

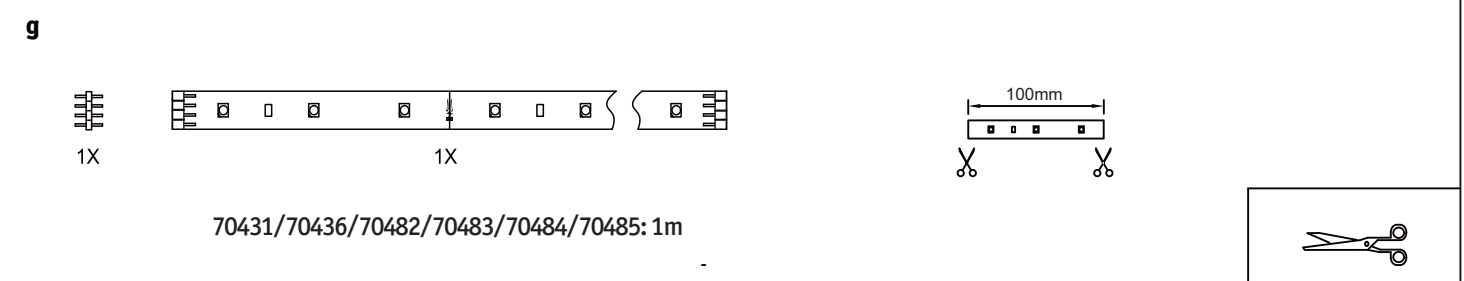
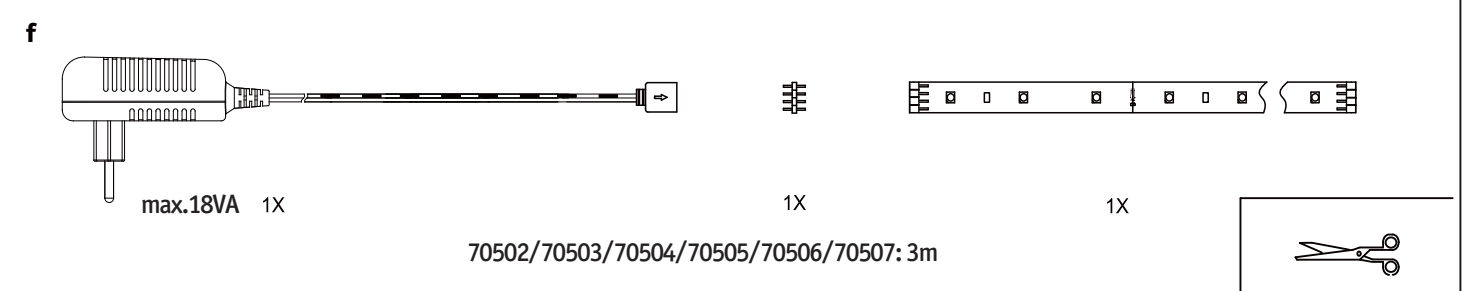
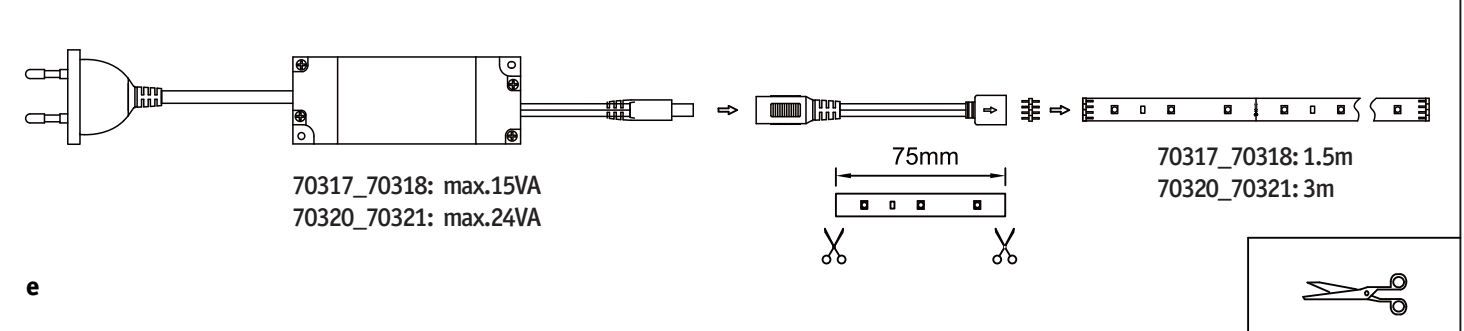
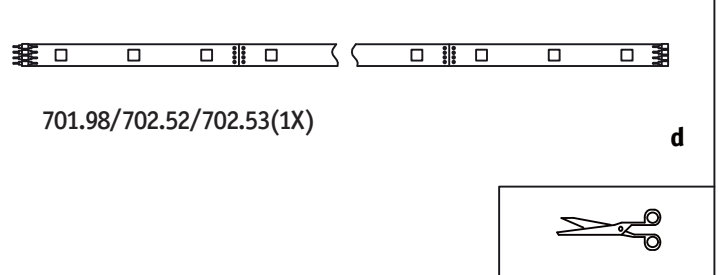
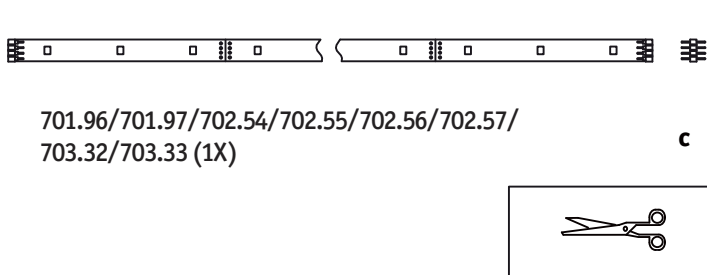
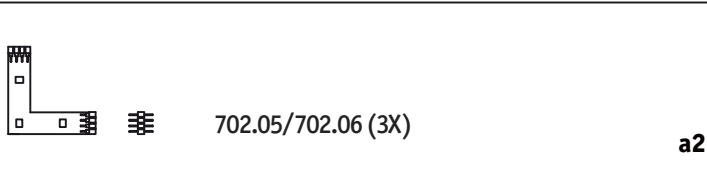
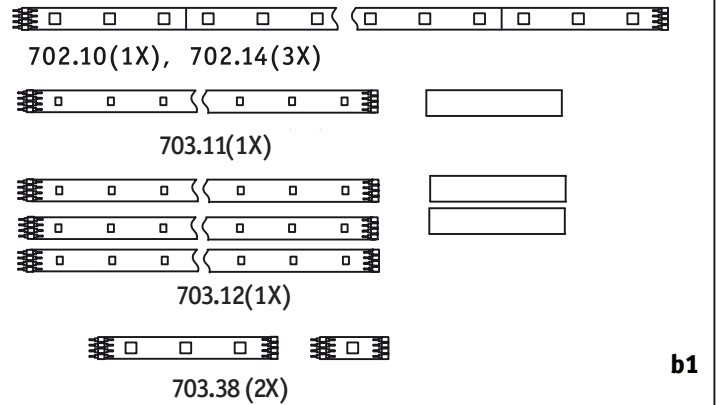
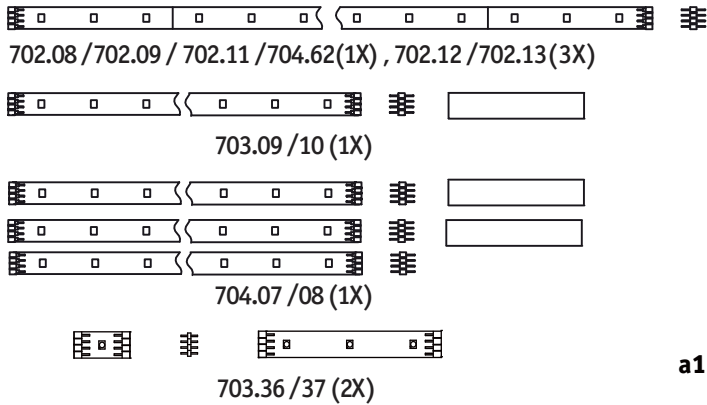

**A**

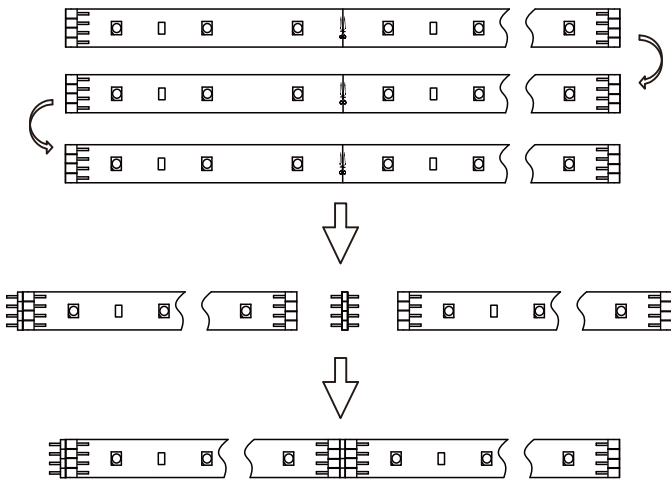

**B**

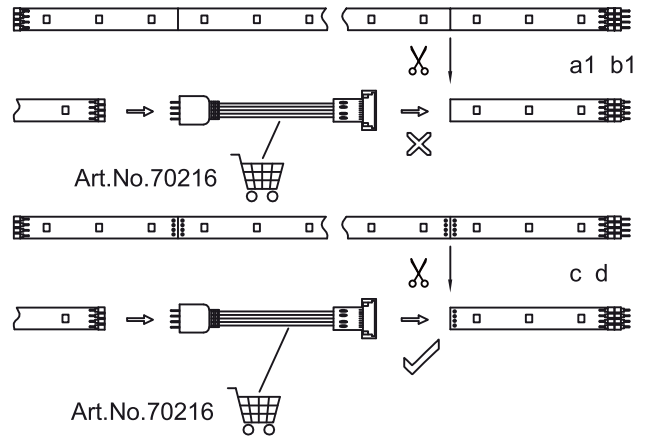

**C**

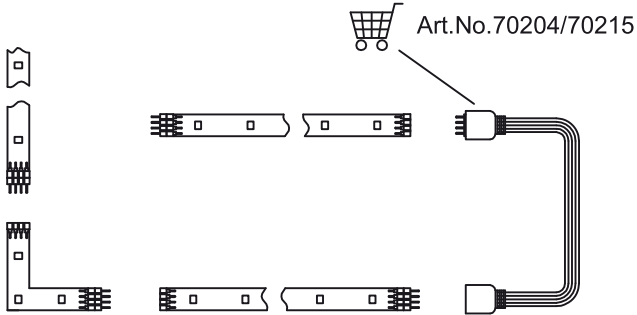

**D**

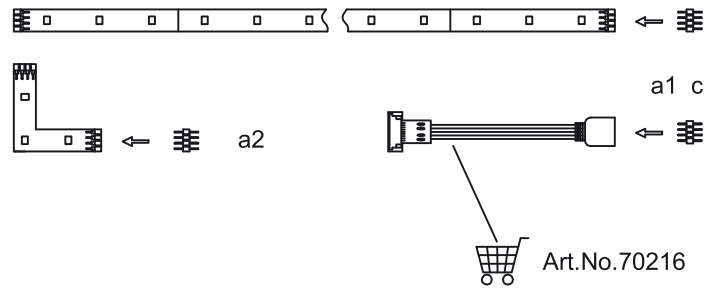

**E**

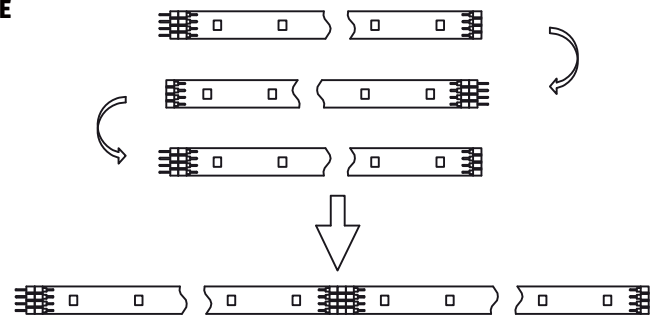

**F**

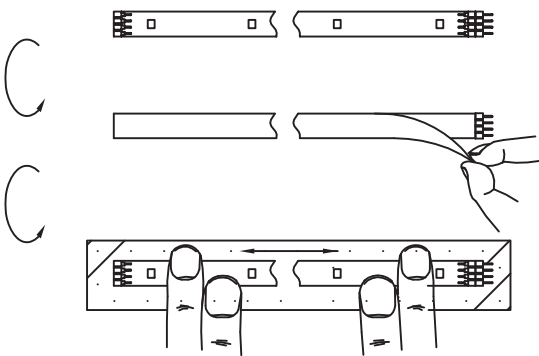

**G**

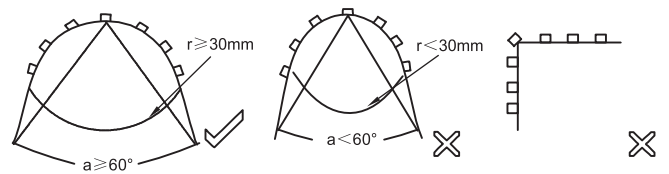

**H**

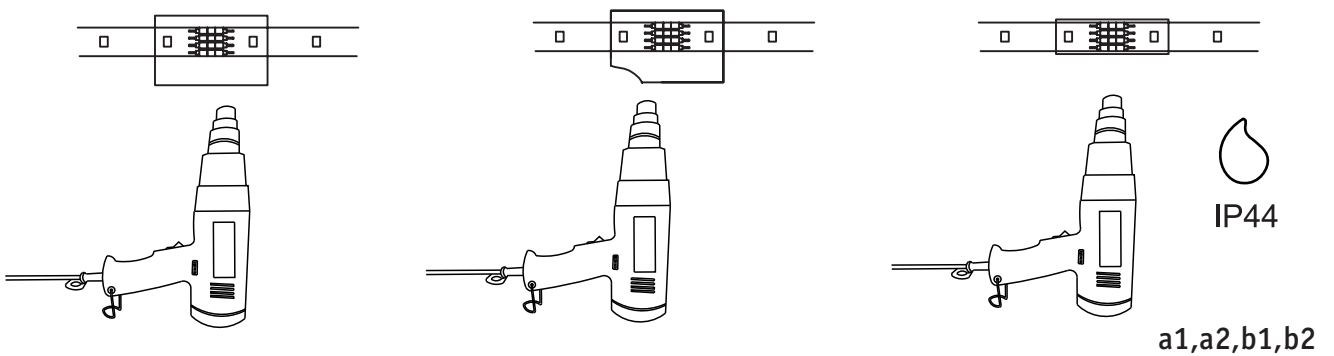

I

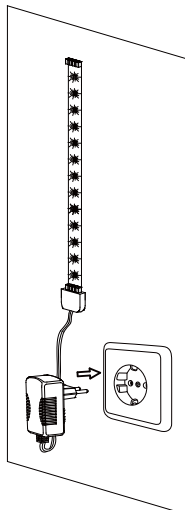

70485/70431 / 70436 / 70482 / 70483/ 70484  
70502 / 70503/ 70504 / 70505/ 70506/70507

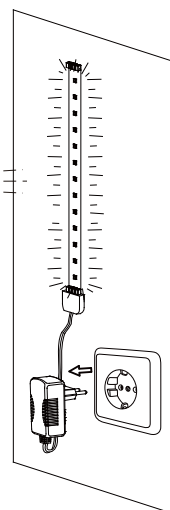

70431 / 70436 / 70482 / 70483/ 70484  
70503/ 70504 / 70505/ 70506/70507

J

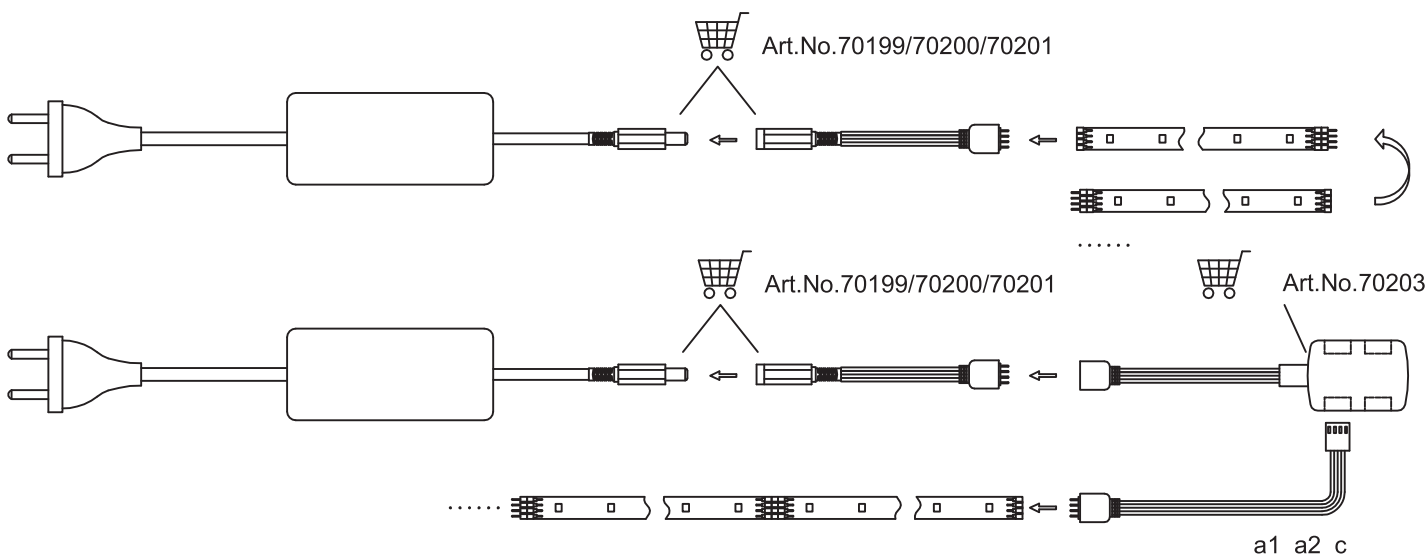

K

